



UCS FT 901 and UCS FR 902 • Setup Guide

IMPORTANT NOTE:

Go to www.extron.com for the complete UCS FT 911 and UCS FR 912 User Guide, installation instructions, and specifications before connecting the product to the power source.



This guide provides basic instructions for an experienced technician to install and configure the Extron UCS 900 Series Fiber Optic USB Extenders. The UCS FT 901 and UCS FR 902 extend USB signals from USB 3.2, 2.0, and 1.1 peripheral devices located up to 492 feet (150 meters) away to a USB 3.2 host computer over multimode fiber optic cable, with a SuperSpeed data transfer rate of up to 5 Gbps.

The transmitter features a USB Type-C connector. The receiver features a built-in active two-port hub that supplies up to 5 V, 1.5 A from each port to power attached devices. See the *UCS FT 901 and UCS FR 902 User Guide*, available at www.extron.com, for more information.

NOTE: The use of a USB 2.0 hub on the UCS FR 902 is not recommended. If a hub is needed in the system, Extron recommends the use of a USB 3.2 hub. Please contact your Extron Applications Engineer (AE) for more details.

Installation

ATTENTION:

- Installation and service must be performed by authorized personnel only.
- L'installation et l'entretien doivent être effectués uniquement par un technicien qualifié.

Connecting Cables

WARNING: Fiber optic connectors emit continuous invisible light, which may be harmful to the eyes; use with caution. Do not look into the fiber optic cable connectors or into the fiber optic cables themselves. Plug the attached dust caps into the optical transceivers when the fiber cable is unplugged.

ADVERTISSEMENT : Les connecteurs de fibre optique émettent une lumière invisible continue, qui peut être dangereuse pour les yeux ; à utiliser avec précaution. Ne pas fixer directement les connecteurs optiques ou les câbles fibre optique. Branchez les protections contre la poussière dans l'ensemble émetteur/récepteur lorsque le câble fibre optique est débranché.

The illustration below shows connections for the UCS FT 901 and UCS FR 902.

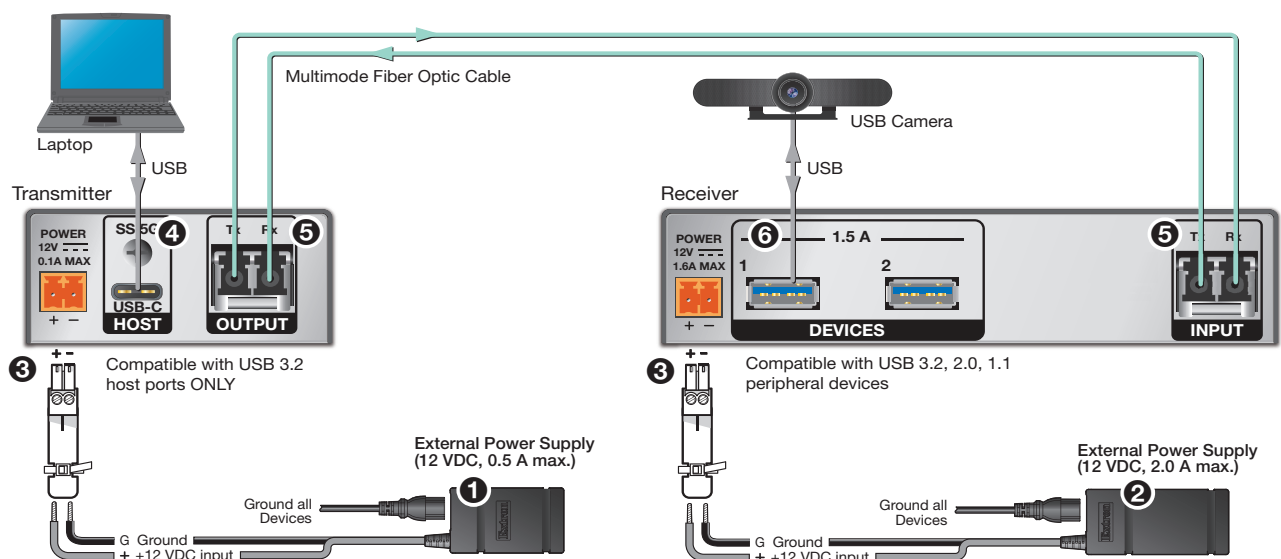

Connecting Power

1. Power off all devices that will be directly connected to the receiver.
2. Wire the provided 24 W power supply (see previous page, ❶) to the receiver 2-pole captive screw connector (❸), and the provided 6 W power supply (❷) to the transmitter (see figure at right for wiring instructions).

NOTE: The UCS FT 901 transmitter can also be powered by the Host device, without the need for the external power supply.

3. Once a unit receives power, the front panel Power LED (see transmitter and receiver illustrations to the right, ❸) lights.

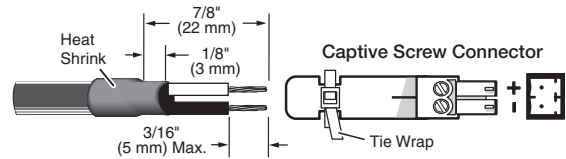

Connecting the Host Transmitter

1. Connect a USB Type C-to-C cable from the Host device to the transmitter HOST port (see previous page, ❹). The HOST LED on the transmitter (see figure at right, ❷) lights as communication between the transmitter and host device is established.

NOTE: The transmitter is compatible only with USB Type C-to-C cables and must be connected to at least a USB 3.2 host port. Ensure that the USB cable used between the Host PC and transmitter host port supports at least USB 3.2 for proper operation. USB 3.2 ports are USB Type-C and labeled with a SuperSpeed trident logo (see images below).



UCS FR 901 - Transmitter

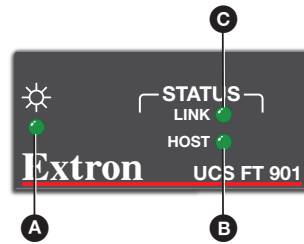

UCS FR 902 - Receiver

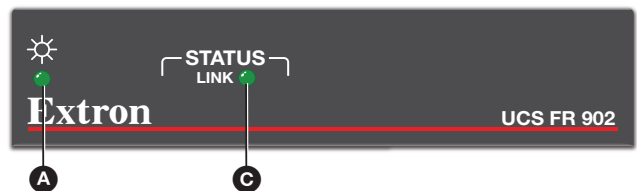

2. Connect a multimode fiber optic cable from the output port of the transmitter to the input port of the receiver (see previous page, ❺).
3. Mount the devices, if appropriate.
4. Power on the host device.
5. The transmitter and receiver LINK LEDs (see figures above right, ❸) light as an indication that a link exists from the host PC to the receiver.
 - If the transmitter is powered by a host PC and is not connected to the receiver, only the HOST LED (❷) lights, and the LINK LED (❸) remains unlit.
 - If the transmitter and receiver are powered locally and connected via fiber cable, but no PC is connected, the LINK LEDs (❸) do not light for either unit.

Connecting the Devices (Receiver)

The receiver is compatible and can be connected to USB 3.2, 2.0, & 1.1 peripheral devices. Connect up to two USB peripheral devices to the receiver Devices ports (see previous page, ❻). The order of connection does not matter.

The UCS FR 902 (receiver) supplies up to 5 V, 1.5 A to each connected peripheral device.

The system is now ready to operate.

For information on safety guidelines, regulatory compliances, EMI/EMF compatibility, accessibility, and related topics, see the [Extron Safety and Regulatory Compliance Guide](#) on the Extron website.